

DL 215 FORTIMO SLM

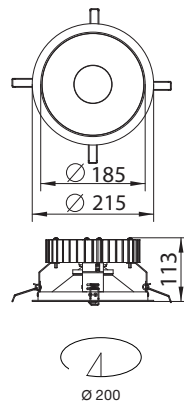

Recessed LED luminaire.
 Body is made of steel and aluminium and it is available in all RAL colours.
 Light source - Philips Fortimo SLM or Osram PrevaLED module.
 Standard EVG ballast, Touch DALI version on request (please add TD after index number).



Index no.	Lumen output	Wattage	Colour temp.	Colour rendering index	Lifetime	Weight
0000-004435.1100/830	1100 lm	12 W	3000 K	82 Ra	50,000 h	2,40 kg
0000-004435.1100/840	1100 lm	12 W	4000 K	82 Ra	50,000 h	2,40 kg
0000-004435.1100/927	1100 lm	12 W	2700 K	97 Ra	50,000 h	2,40 kg
0000-004435.1100/930	1100 lm	12 W	3000 K	97 Ra	50,000 h	2,40 kg
0000-004435.1100/940	1100 lm	12 W	4000 K	97 Ra	50,000 h	2,40 kg
0000-004435.2000/830	2000 lm	21 W	3000 K	82 Ra	50,000 h	2,40 kg
0000-004435.2000/840	2000 lm	21 W	4000 K	82 Ra	50,000 h	2,40 kg
0000-004435.2000/927	2000 lm	21 W	2700 K	97 Ra	50,000 h	2,40 kg
0000-004435.2000/930	2000 lm	21 W	3000 K	97 Ra	50,000 h	2,40 kg
0000-004435.2000/940	2000 lm	21 W	4000 K	97 Ra	50,000 h	2,40 kg
0000-004435.3000/830	3000 lm	30 W	3000 K	82 Ra	50,000 h	2,40 kg
0000-004435.3000/840	3000 lm	30 W	4000 K	82 Ra	50,000 h	2,40 kg
0000-004435.3000/927	3000 lm	30 W	2700 K	97 Ra	50,000 h	2,40 kg
0000-004435.3000/930	3000 lm	30 W	3000 K	97 Ra	50,000 h	2,40 kg
0000-004435.3000/940	3000 lm	30 W	4000 K	97 Ra	50,000 h	2,40 kg
0000-004435.3000/930CW	3000 lm	39 W	Crisp White	92 Ra	50,000 h	2,40 kg

IP20 230 V / 50 Hz F ⚡ CE ⚠️